



Automated Pure Water Product Instructions

Flex Shaft Mineral Extractor Kit

Instructions for Flex Shaft Mineral Extractor

Changing of center tube:

- 1 - Lay unit on its side with the white cap facing down, this allows for the removal of the standard center tube without losing the silicone lubricant.
- 2 - Remove the standard center tube
- 3 - Replace with the hinged center shaft, top section (the 25" long white tube).
- 4 - Using the hinged center shaft, place the lower section of the center shaft (the long shaft with the clear flex tubing hinges) into tank, push down to bottom of tank.

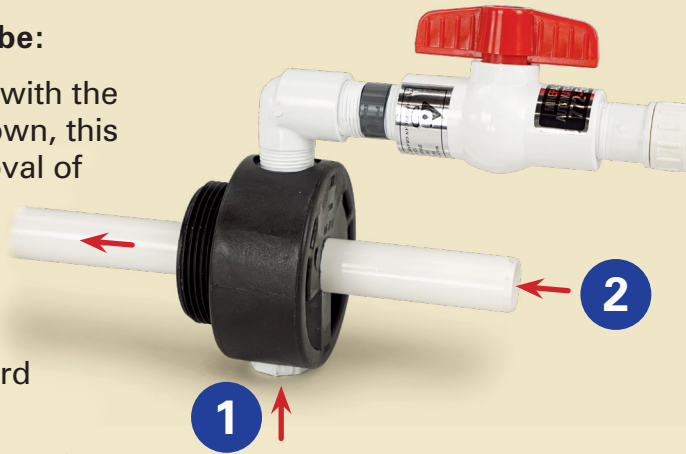

If necessary, put end of garden hose into the end of clear tubing to jet flex shaft to bottom of tank.

At this point:

- add the upper assembly to center shaft
- lower the adapter
- line up threads and tighten assembly to top of tank
- Attach hose and proceed to remove media from tank



NOTE: For best results, warm the clear hinges with hot water just prior to installing in tank.

NELSEN

C O R P O R A T I O N

3250 Barber Road
Norton, OH 44203
Phone: 800.362.9686
Fax: 888.544.8780

14035 W. El Cielo
Goodyear, AZ 85338
Phone: 866.445.4299
Fax: 602.442.0447

4410 E Adamo Dr Suite 102
Tampa, FL 33619
Phone: 813.712.2270
Fax: 813.712.2274

1012 Assembly Circle - # 100
Schertz, TX 78154
Phone: 855.674.0357
Fax: 210.714.2571

NelsenCorp.com Commercial.NelsenCorp.com VestaWater.com